

1/4" - Whitworth (INSERT SCREW)

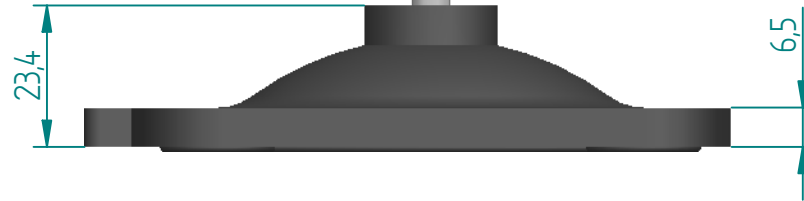

Ø 11 (4 Holes)

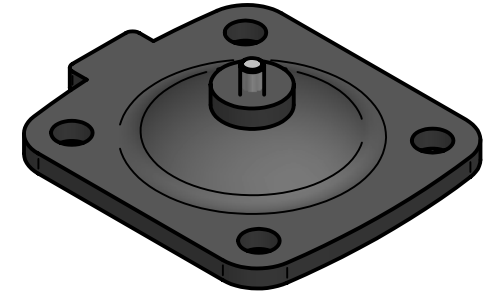

SCALE
1:2



Replacement Diaphragm for :-
 OEM PART = DA040ER
 USED ON 1.5" (DN40) Diaphragm Valve

REVISION HISTORY			
REV	DESCRIPTION	DATE	APPROVED
D	OEM PART changed from DA040-EF to DA040ER	05/12/21	JB

	NAME	DATE
DRAWN	M.MC KEON	12/05/21
CHECKED	M.MC KEON	01/02/20

Material - EPDM

Complies with CFR 177.2600
 and Conforms to
 USP Class VI Biological Reactivity
 Tests Section #87 and #88



TITLE
DD15-SE7

SIZE A
FOOT PRINT DIMENSIONS REV D

FILE NAME: DD15-SE7.dft

SCALE: 1:1.25 | GDE-DN40S | SHEET 1 OF 1

Disclaimer - Diaphragm Direct® does not manufacture, represent, nor sell OEM valves or diaphragms manufactured by any other company. Diaphragm Direct® brand diaphragms are not sponsored by any other manufacturers. Any name, model, part number, brand, image, material or referral is for descriptive purposes only. Diaphragm Direct® brand replacement diaphragms are guaranteed to fit OEM equipment and meet or exceed OEM specifications. Diaphragm Direct® brand replacement diaphragms are covered by the standard Diaphragm Direct® limited product warranty.